

AcoustiCradle Floating Floor

AcoustiCradle are made from 100% recycled rubber crumb materials and offer a cost-effective acoustic flooring solution by de-coupling the floating floor from the structural floor in way of towers, into which a suspended timber batten system is installed reducing direct linkage.

GENERAL

Introduction **AcoustiCradle** is a very effective way of decoupling a finish floor from the substrate where depth tolerances are available and floor build-ups are possible. The cradles and floating timber floor systems are a much deeper system than other Acoustiblok solutions but can offer complete de-coupling of flooring levels and can further complement Acoustiblok1600 3mm and Acoustiblok32100 6mm Acoustic Insulation Membranes.

Applications **AcoustiCradle** is suitable for use in new build and refurbishment projects. They can also provide a convenient void between the subfloor and finish floor for service runs.

Authority **AcoustiCradle** has been acoustically tested in various assemblies including laminate and ceramic surfaces and are approved as Document E compliant for conversion and new build standards.

Acoustiblok Acoustic Insulation Systems far exceed Document E Building Regulation requirements.

Acoustiblok is a UL Approved Company.

DESCRIPTION

AcoustiCradle might offer an increased floor height but with a fully de-coupled platform on which to lay a new sub floor. The cradles can be easily adjusted to accommodate varying finished floor heights.

Composition, manufacture **AcoustiCradle** is formed from recycled rubber crumb.

Accessories include varying height base packers to increase height where necessary.

Dimensions, weight are shown in the table overleaf.

Appearance is a dense black crumb turret type block of resilient recycled rubber.

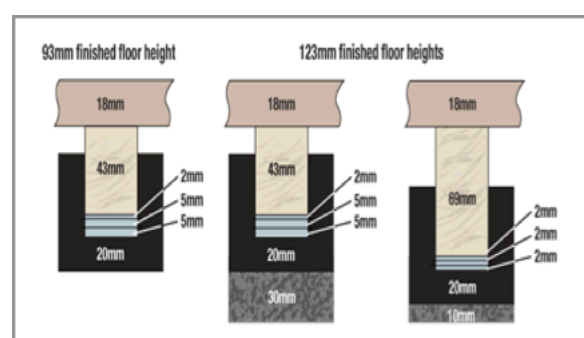
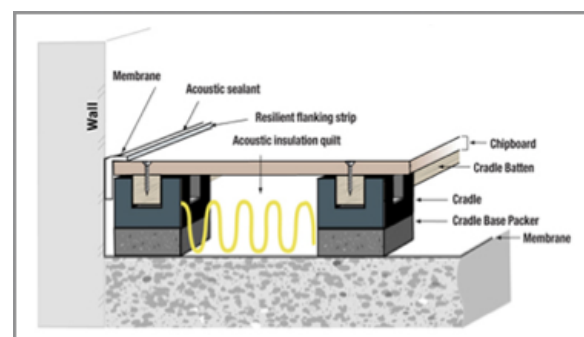
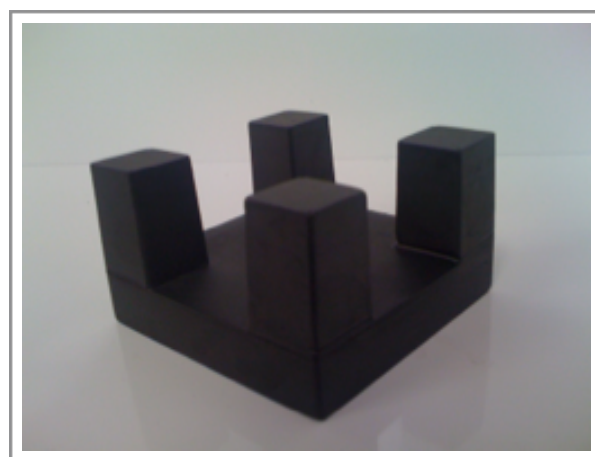

Dimensions, weight *AcustiCradle*

Depth (mm) : 60mm overall
(20mm base, 40mm tower)
Dimensions : 100mm x 100mm
Weight (kg) : 0.25

PERFORMANCE

Mechanics Material will not compress when used under standard board / sheet flooring materials.

Acoustic Delta ΔL_w 28dB (BS EN ISO 140-8:1998)

Fire Low Classification (BS 4790:1987)

Biological Proof against mildew growth, water resistant.

Odour No objectionable odour.

Electrical *AcustiCradle* has high electrical resistance.

Compatibility *AcustiCradle* can be used with all common building materials.

SITWORK

Health and safety *AcustiCradle* have a low classification. Skin that comes into contact with molten material should be immediately immersed in cold, running water until cooled before removal of the material is attempted.

Handling and storage Materials are boxed and are moderately light weight. They should be stored in a sprinklered warehouse at a temperature below 60°C.

Installation The cradles are positioned at approximately 500mm centres across the entire treated area and levelled on site. The timber batten system sits into the cradles to offer a raised de-coupled sub floor level to be finished with board / sheet material.

SUPPLY

All products are supplied direct from the company.

Acoustiblok installation details

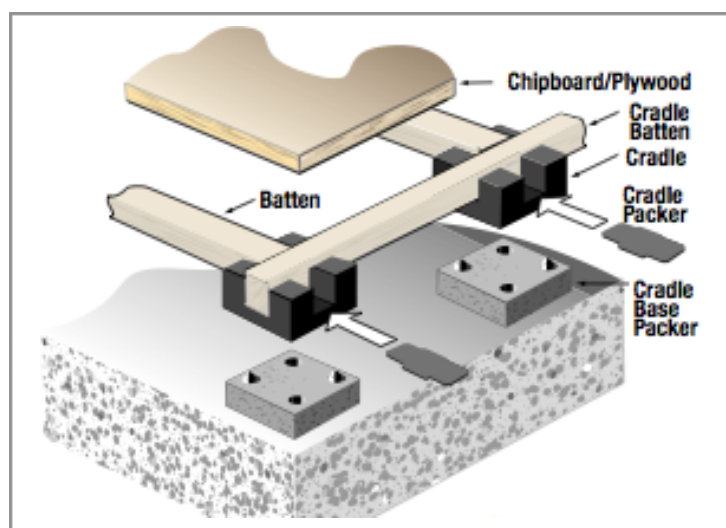
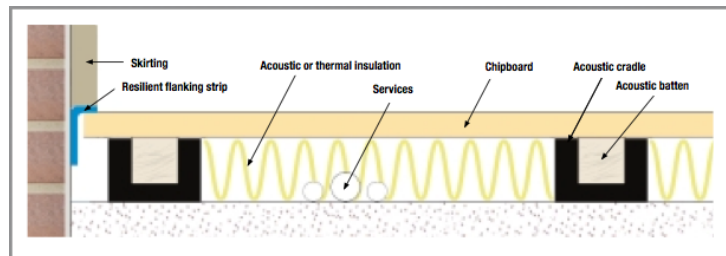

SERVICES

The company provides the following services to specifiers:

- supply only
- technical advice
- site visit, acoustic survey feasibility study and specification report
- consultancy, working alongside sub-contractors, builders and maintenance teams

REFERENCES

Information on acoustic underlays, tapes and caulk is available from the company.

Information on UL certification is available:

- directly from the company's website, or
- from www.ul.com using classification file number R21490.

Acoustiblok UK Limited

Tel: 01622 840289

Fax: 0844 779 2422

Email: info@acoustiblok.co.uk

Website: www.acoustiblok.co.uk